

GATERON

佳达隆电子科技 有限公司（惠州）

By GATERON

GATERON

卫星轴组件规格介绍说明

GATERON Stabilizer Assembly Specification Manual

项目部 2025.11.11

Project Division 2025.11.11

Stabilizer assembly classification description:

1、卫星轴组件分类说明：

钢板卫星轴组件（KS-51系列）

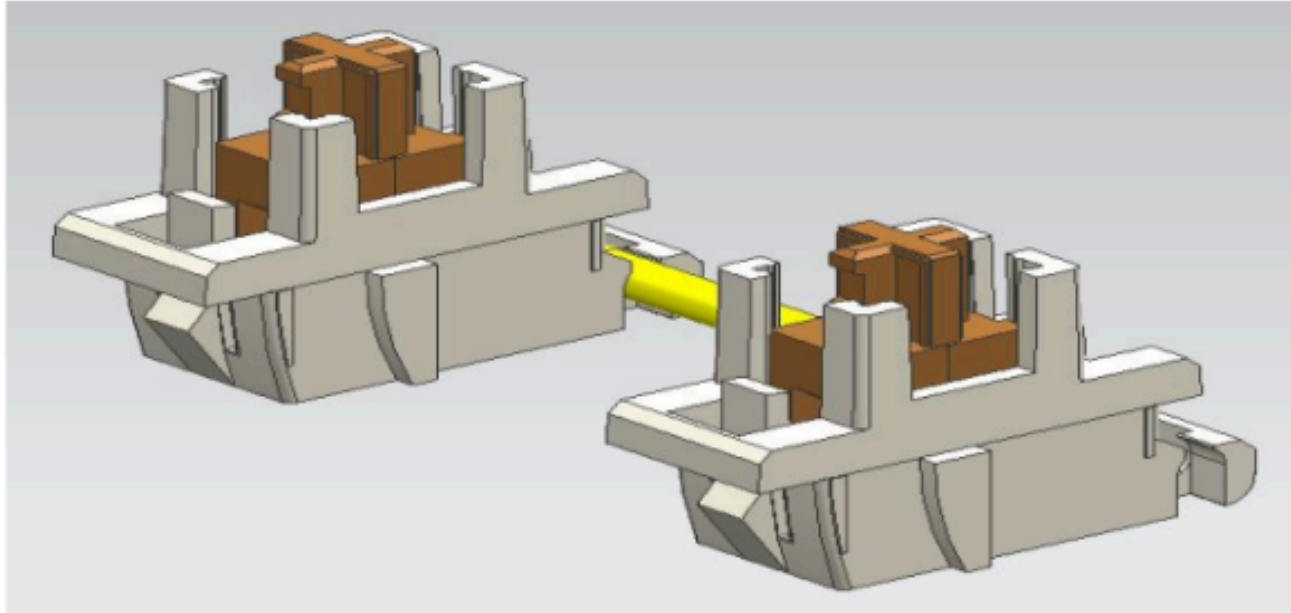

钢板卫星轴：通过卡扣固定在键盘定位板（钢板）上，依赖定位板开孔精度，可能导致松紧不一；
调试与维护：仅需拆卸对应键位轴体即可调校，维护便捷；但兼容性受键帽和定位板限制；
稳定性：钢板卫星轴可能因定位板误差产生晃动；
应用场景：钢板卫星轴多用于量产键盘，成本低且易维护。

Plate Mount Stabilizer Assembly (KS-51 Series)

- Plate-mounted stabilizer: It is fixed to the keyboard plate (steel plate) with a clip and depends on the accuracy of the plate's opening, so there is a possibility of loosening or tightness.
- Adjustment and Maintenance: Adjustment is possible by simply removing the corresponding key switch, making maintenance easy. However, compatibility with key caps and plates is limited.
- Stability: Plate-mounted stabilizers can be unstable due to plate inaccuracies.
- Usage scenarios: Plate-mounted stabilizers are often used in mass-produced keyboards, and are low-cost and easy to maintain.

螺母卫星轴组件（KS-53系列）

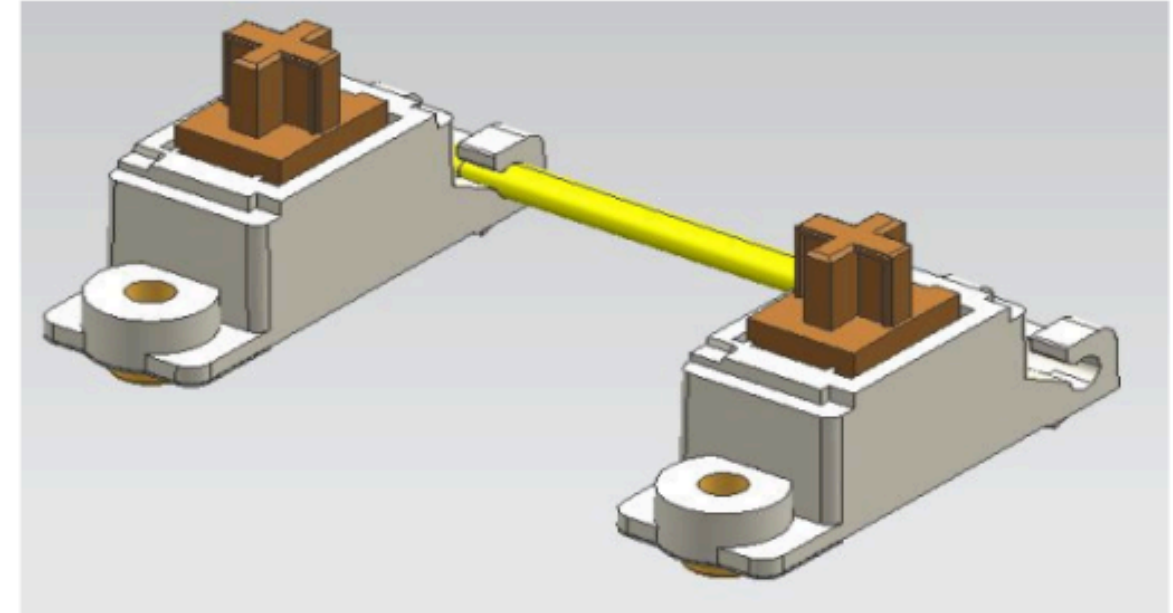

螺母卫星轴：直接通过螺丝固定在PCB主板上，不受定位板影响，结构更稳固；
调试与维护：需拆解出整块PCB才能进行调校，操作繁琐，且易出现钢丝音或空键程问题；
稳定性：PCB卫星轴固定更牢固，杂音控制更优；
应用场景：PCB卫星轴常见于客制化键盘，追求稳定性和一致性。

Screw-in type stabilizer assembly (KS-53 series)

- Screw-in stabilizer: Fixed directly to the PCB main board with screws, no plate interference, more robust structure.
- Adjustment and maintenance: Adjustment requires removing the entire PCB, which is cumbersome and prone to problems such as stabilizer noise (wire noise) and idle stroke.
- Stability: PCB mounted stabilizer provides more stable fixation and better noise control.
- Usage scenarios: PCB mount stabilizers are common in custom keyboards where stability and consistency are required.

Plate-mounted stabilizer assembly plate opening standard reference dimensions

2、钢板卫星轴组件定位板开孔标准参考尺寸

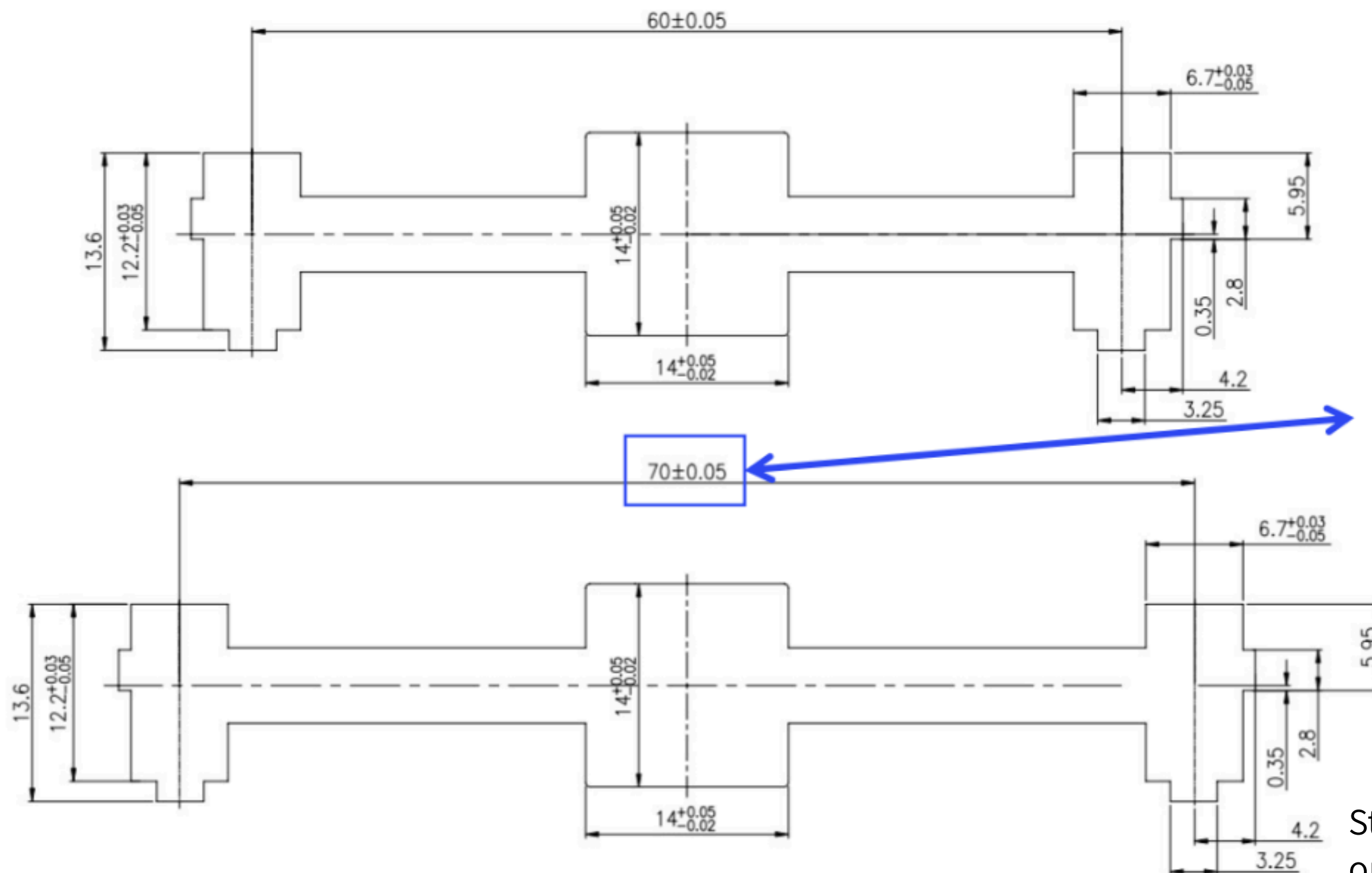

中心距**60mm**及**70mm**规格定位板开孔标准参考图，不同规格只需调整此处中心距尺寸即可，其它位置完全一致

Standard reference diagram of plate opening for 60mm and 70mm center distance standards. For different standards, only the center distance dimension needs to be adjusted, and other positions will be completely consistent.

PCB opening standard reference dimensions for screw-in type stabilizer assembly

3、螺母卫星轴组件PCB板开孔标准参考尺寸

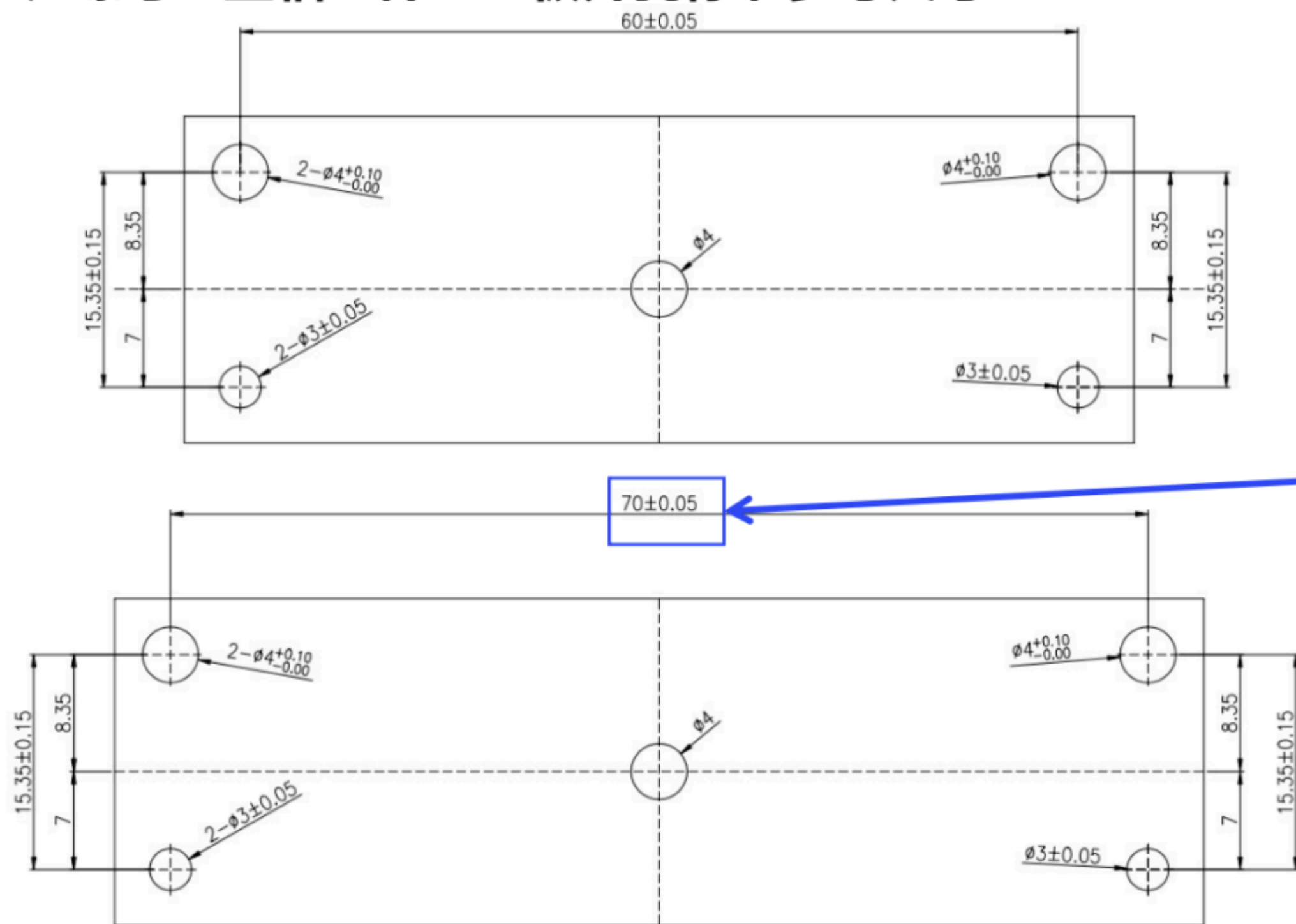

中心距60mm及
70mm规格PCB板开
孔标准参考图，不
同规格只需调整此
处中心距尺寸即可，
其它位置完全一致

This is a reference diagram of the PCB board opening standard for 60mm and 70mm center distances. For different standards, you only need to adjust the center distance dimensions, and the other positions will be completely consistent.

4、钢板卫星轴组件配合尺寸图档

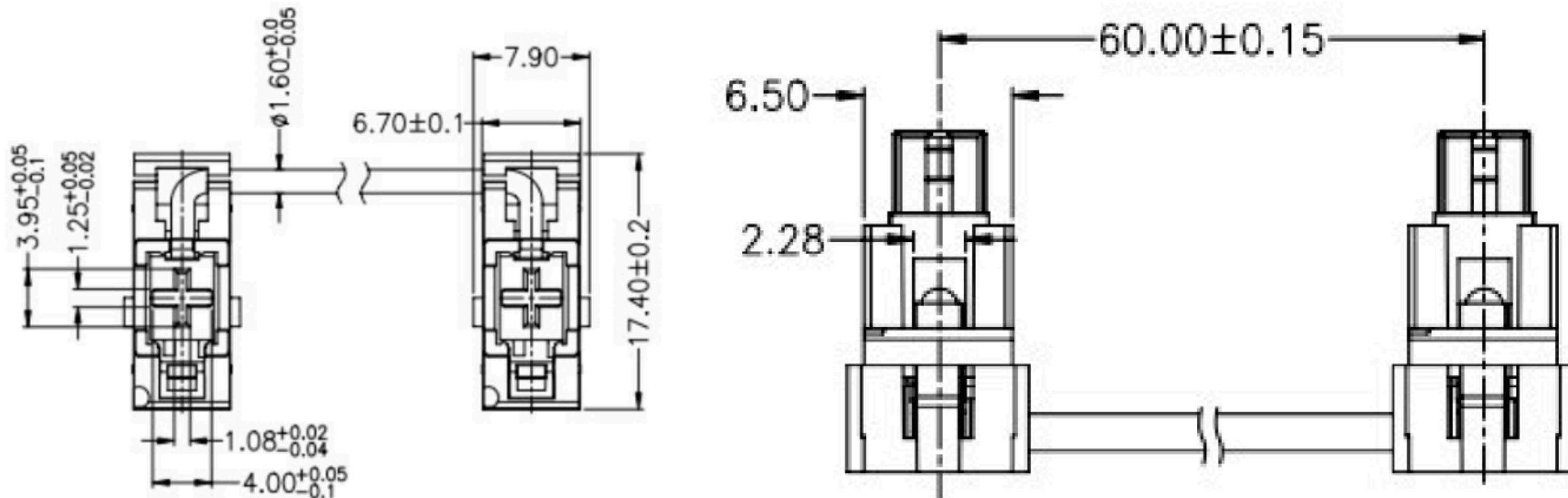

空格键卫星轴组件配合尺寸图，以中心距60mm作为参考

Fitting dimension diagram of the space key stabilizer assembly.
Center distance of 60 mm is used as reference.

5、螺母卫星轴组件配合尺寸图档

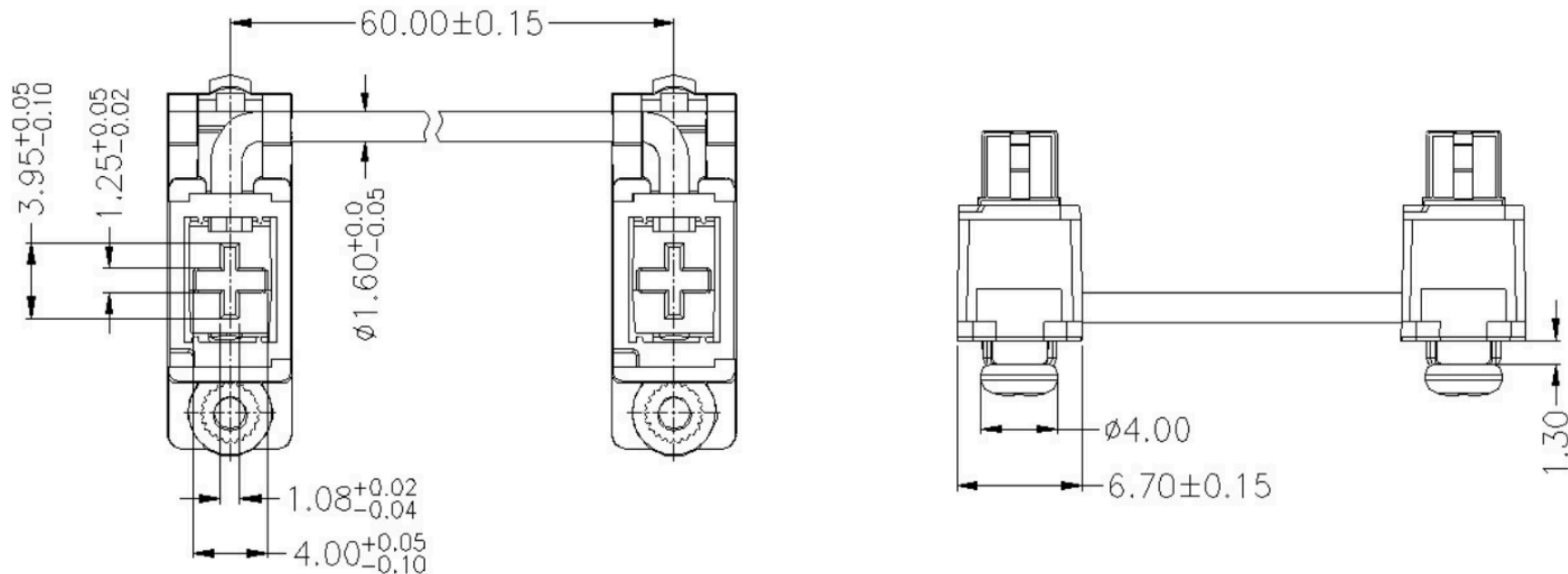

空格键卫星轴组件配合尺寸图，以中心距60mm作为参考

Fitting dimension diagram of the space key stabilizer assembly.
Center distance of 60 mm is used as reference.

THANKS

佳达隆
GATERON

Mr. Li 13928373697 (国内) RAY@gateron.com www.gateron.cn

Tony 13923602534 (国外) Tony@gateron.com www.gateron.net

广东省惠州市仲恺高新区中韩(惠州)产业园松北路1号

No. 1, Songbei Road, China-Korea (Huizhou) Industrial Park,
Zhongkai High tech Zone, Huizhou City, Guangdong Province, China

